

CONFERENCES
& EVENTS



Hilton
LONDON PADDINGTON



WELCOME TO HILTON LONDON PADDINGTON

A historic Art Deco hotel in an enviable location, Hilton London Paddington is one of London's best connected hotels. Connected to Paddington Station via footbridge and just 15 minutes away from Heathrow Airport via Heathrow Express, delegates have the comfort of stepping into their room minutes after they land in the capital.

Hilton London Paddington has been known for hosting large conferences and events from international corporate congresses to day-to-day meetings and employee celebrations. Your dedicated Event Manager will ensure every detail is taken care of.



HEATHROW EXPRESS

Our long-term partnership with Heathrow Express allows us to offer our guests 10% discount on their train tickets from Heathrow Airport when booked via our dedicated link exclusive to our guests. Special group rates are also available through your dedicated Conference Manager. With roof-to-roof connectivity this is the ideal beginning of your productive London journey.

LOCATION

In the heart of London Hilton London Paddington offers modern facilities in a fantastic location at Paddington Station. Located just 15 minutes from Heathrow airport via the Heathrow Express and with four London Underground lines on the doorstep — Circle, Hammersmith & City, District, and Bakerloo — the hotel remains one of the best connected hotels in the capital.

Exploring some of London's greatest attractions, such as Hyde Park, Kensington Palace, Marble Arch and Oxford Street are all easily reachable on foot.

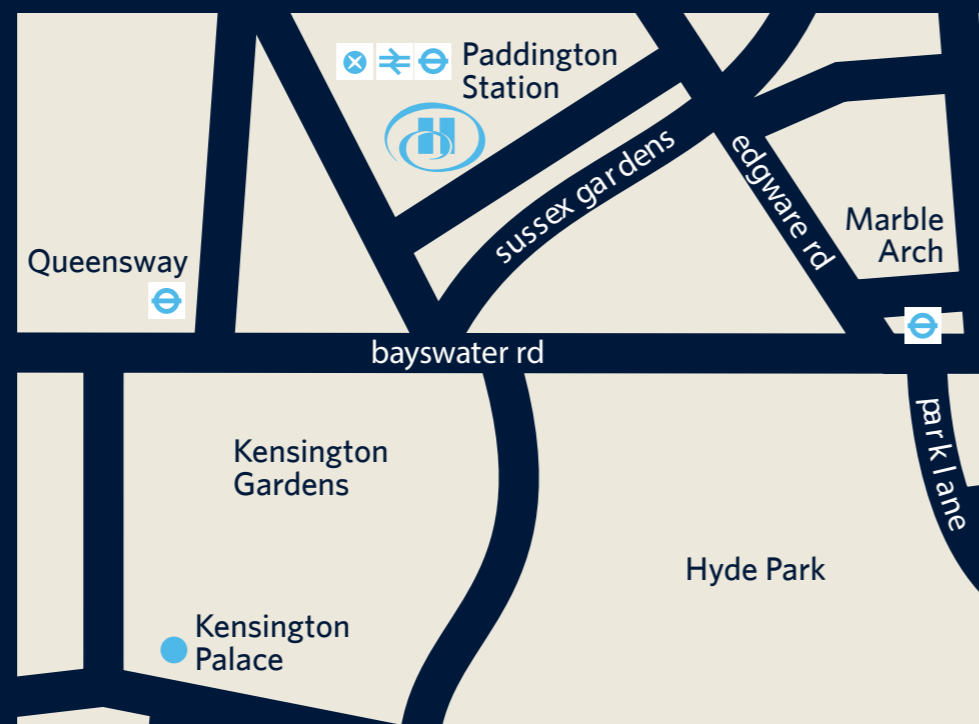

OUR ROOMS



GUEST ROOMS

Wake up in a spacious Art Deco style room with a modern twist. Bright and airy, each room includes large opening windows and a host of premium amenities, an easy chair, large working desk and marble bathroom. Stay connected with complimentary wireless Internet and enjoy movies on-demand on the flat-screen TV.

The hotel also offers a variety of family and interconnecting rooms available for up to 4 people offering space and comfort for the whole family.

EXECUTIVE ROOMS AND SUITES

Hilton London Paddington has an array of spacious Executive Rooms and Suites with complimentary access to the Executive Lounge offering food and refreshments throughout the day.

Along with Standard, Deluxe, Family and Premium GWR Tower Rooms, this grand historic Hotel has something to offer to suit everyone's taste and needs.

GWR TOWER ROOMS

The stylish GWR Tower Rooms, located in an exclusive wing, offer upscale accommodation that is truly something special. Enjoy an array of additional extras including more space, separate relaxation and work areas, a 40+ inch HDTV, a modern four-fixture bathroom, upgraded bathroom amenities, and complimentary WiFi.



SELF-CONTAINED CONFERENCE FLOOR (1st FLOOR)

With 10 pillar-less meeting rooms on the self-contained conference floor, including two majestic ballrooms with dedicated foyer and a sunlit atrium ideal for networking, our hotel offers the exclusivity and convenience for your event needs. Our comprehensive conferences packages are available to provide you with all the flexibility required for the success of your event.

CAPACITIES AND DIMENSIONS

	Boardroom	U-Shape	Theatre	Classroom	Cabaret	Banquet	Dinner Dance	Reception	Floor	Dimensions L x W x H (m)	Air-conditioning	3 Phase Power	Sound System	Blackout	Natural Daylight	Dimmer	Chandelier
Great Western 1	70	60	350	160	150	280	240	300	1st	25.37 x 11.12 x 4.87	•	•	—	—	•	•	•
Great Western 2	40	40	140	70	64	100	80	120	1st	12.18 x 11.12 x 4.87	•	•	—	—	•	—	•
Hobart	10	—	24	6	12	12	—	—	1st	6.66 x 4.54 x 3.09	•	—	—	—	•	—	—
Campanula	18	—	32	21	24	24	—	24	1st	7.54 x 5.38 x 3.09	•	—	—	—	•	—	—
Hurricane	10	—	27	6	8	12	—	—	1st	4.82 x 4.60 x 2.68	•	—	—	—	•	—	—
Kingfisher	18	—	32	18	16	20	—	20	1st	7.22 x 5.45 x 2.69	•	—	—	—	•	—	—
Redstar	25	22	48	23	24	30	—	30	1st	9.15 x 6.15 x 3.10	•	—	—	—	•	—	—
Comet	10	—	24	6	8	12	—	—	1st	5.50 x 4.50 x 2.67	•	—	—	—	•	—	—
Hotspur	8	—	18	6	8	8	—	—	1st	3.58 x 3.28 x 2.67	•	—	—	—	•	—	—
King George V	18	20	32	21	18	20	—	20	1st	7.58 x 5.36 x 2.89	•	—	—	—	—	—	—



GREAT WESTERN 1 BALLROOM

A walk up the impressive lobby staircase leads you to this majestic Great Western 1 ballroom, located on the first floor, waiting to host your guests. With 282 sq. metres of space this pillar-less room, filled with natural daylight, can take up to 350 guests. Delegates will enjoy comfortable modern facilities as well as the use of the dedicated foyer area for pre- or post-event networking, coffee breaks or a hearty lunch. The closely located cloak and rest rooms and fully equipped Business Centre, offer everything your guests might need at an easy reach. Your dedicated event manager will ensure your event is taken care of until the very last detail.

CAPACITIES AND DIMENSIONS

	Boardroom	U-Shape	Theatre	Classroom	Cabaret	Banquet	Dinner Dance	Reception	Floor	Dimensions L x W x H (m)	Air-conditioning	3 Phase Power	Sound System	Blackout	Natural Daylight	Dimmer	Chandelier
Great Western 1	70	60	350	160	150	280	240	300	1st	25.37 x 11.12 x 4.87	•	•	—	—	•	•	•

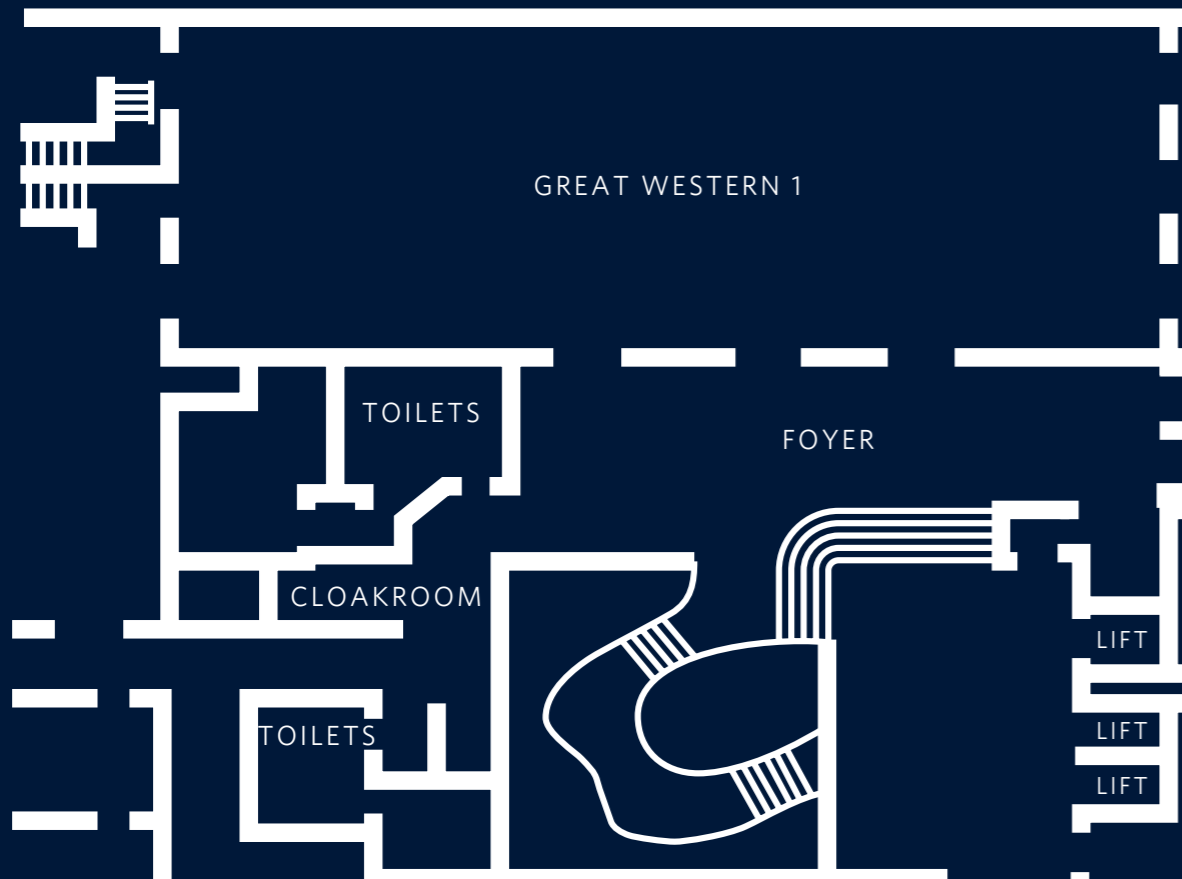

GREAT WESTERN 2 BALLROOM

Great Western 2 ballroom, located on the first floor and connected to Great Western 1, can accommodate up to 140 guests. This pillar-less room, filled with natural daylight, will offer your delegates comfortable modern facilities as well as the use of the sunlit atrium area for pre- or post-event networking, coffee breaks or a hearty lunch. The closely located cloak and rest rooms and fully equipped Business Centre, offer everything your guests might need at an easy reach. Your dedicated event manager will ensure your event is taken care of until the very last detail.

CAPACITIES AND DIMENSIONS

	Boardroom	U-Shape	Theatre	Classroom	Cabaret	Banquet	Dinner Dance	Reception	Floor	Dimensions L x W x H (m)	Air-conditioning	3 Phase Power	Sound System	Blackout	Natural Daylight	Dimmer	Chandelier
Great Western 2	40	40	140	70	64	100	80	120	1st	12.18 x 11.12 x 4.87	•	•	—	—	•	—	•

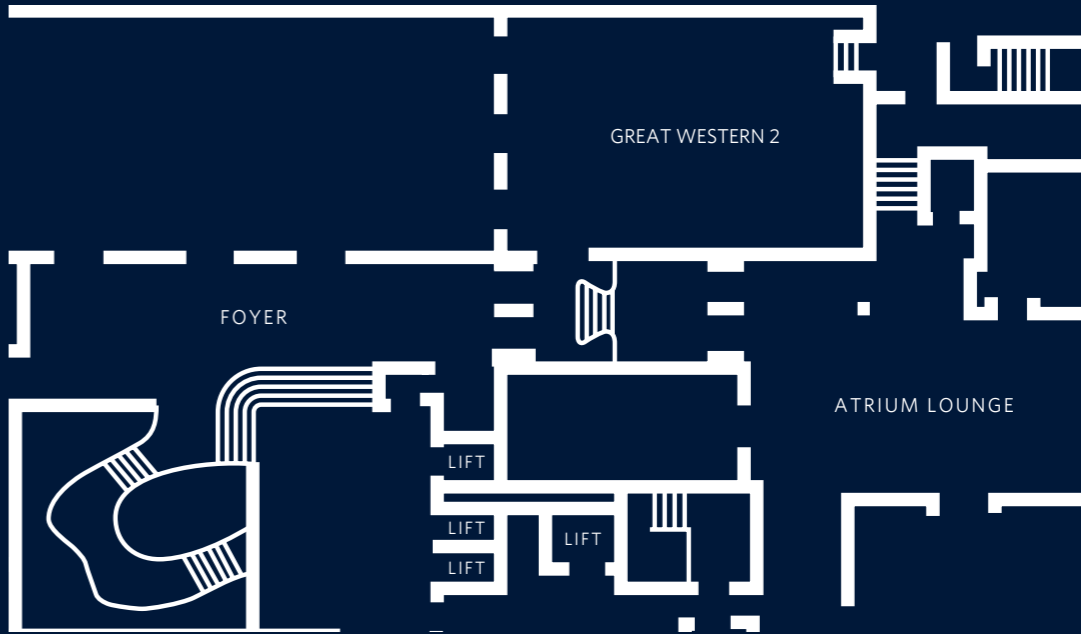

SELF-CONTAINED CONFERENCE FLOOR (GROUND FLOOR)

Five sunlit pillar-less meeting rooms are conveniently located on the ground floor of the hotel to provide you with all the flexibility you need. Available for exclusive hire and located in close proximity to the Reception and Concierge desks. The conference corridor also has dedicated rest rooms in order to provide your delegates with the full comfort during their meeting.

CAPACITIES AND DIMENSIONS

	Boardroom	U-Shape	Theatre	Classroom	Cabaret	Banquet	Dinner/Dance	Reception	Floor	Dimensions L x W x H (m)	Air-conditioning	3 Phase Power	Sound System	Blackout	Natural Daylight	Dimmer	Chandelier
MacIver	25	24	60	18	32	40	30	40	Ground	8.32 x 6.15 x 3.27	•	—	—	—	•	•	—
Thunderbolt	28	25	70	28	40	50	30	50	Ground	9.98 x 6.70 x 3.38	•	—	—	—	•	•	—
Maine	10	—	18	6	8	12	—	—	Ground	5.03 x 4.70 x 3.38	•	—	—	—	•	•	—
Tangley	10	—	18	6	8	12	—	—	Ground	4.82 x 4.74 x 3.38	•	—	—	—	•	•	—
Talisman	10	—	18	6	8	12	—	—	Ground	5.08 x 4.80 x 3.38	•	—	—	—	•	•	—
Avon	8	—	—	—	—	—	—	—	Ground	5.35 x 3.18 x 2.21	•	—	—	—	•	•	—

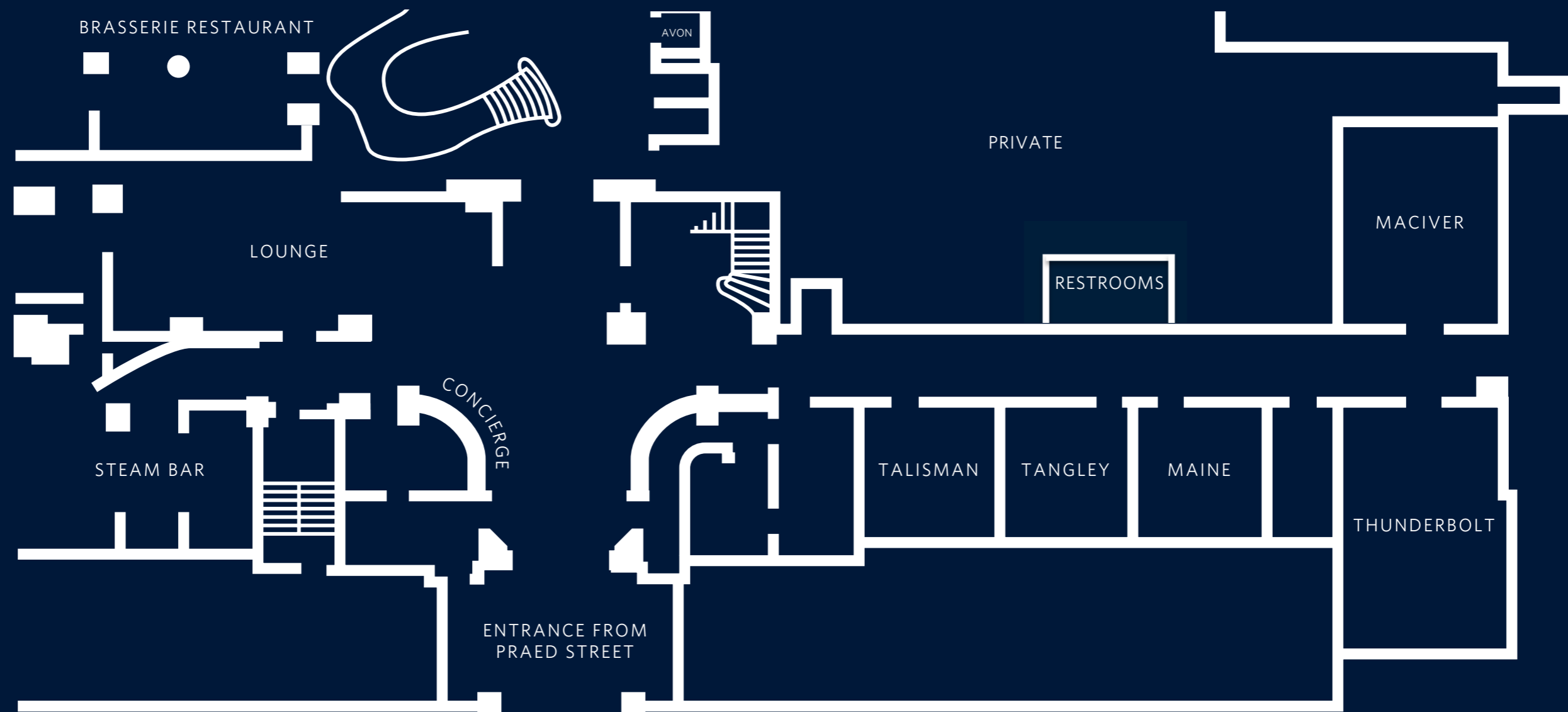



SUNLIT ATRIUM



THUNDERBOLT

Located on the ground floor Thunderbolt meeting room offers a great flexibility to suit any meeting requirements for up to 70 people. With large windows in multiple directions there is abundance of natural daylight, ideally suited for medium-sized meetings or work sessions. Fully equipped with a large screen, stationery, flipchart, AV equipment and modern tables with inbuilt sockets and ergonomic chairs for your convenience, this meeting room has everything you will need to deliver a successful meeting.

CAPACITIES AND DIMENSIONS

	Boardroom	U-Shape	Theatre	Classroom	Cabaret	Banquet	Dinner Dance	Reception	Floor	Dimensions L x W x H (m)	Air-conditioning	3 Phase Power	Sound System	Blackout	Natural Daylight	Dimmer	Chandelier
Thunderbolt	28	25	70	28	40	50	30	50	Ground	9.98 x 6.70 x 3.38	•	—	—	•	•	—	



MACIVER

Located on the ground floor Maciver meeting room offers a great flexibility to suit any meeting requirements for up to 60 people. With large windows there is abundance of natural daylight, ideally suited for medium-sized meetings or work sessions. Fully equipped with a large screen, stationery, flipchart, AV equipment and modern tables with inbuilt sockets and ergonomic chairs for your convenience, this meeting room has everything you will need to deliver a successful meeting.

CAPACITIES AND DIMENSIONS

	Boardroom	U-Shape	Theatre	Classroom	Cabaret	Banquet	Dinner Dance	Reception	Floor	Dimensions L x W x H (m)	Air-conditioning	3 Phase Power	Sound System	Blackout	Natural Daylight	Dimmer	Chandelier
Maciver	25	24	60	18	32	40	30	40	Ground	8.32 x 6.15 x 3.27	•	—	—	—	•	•	—

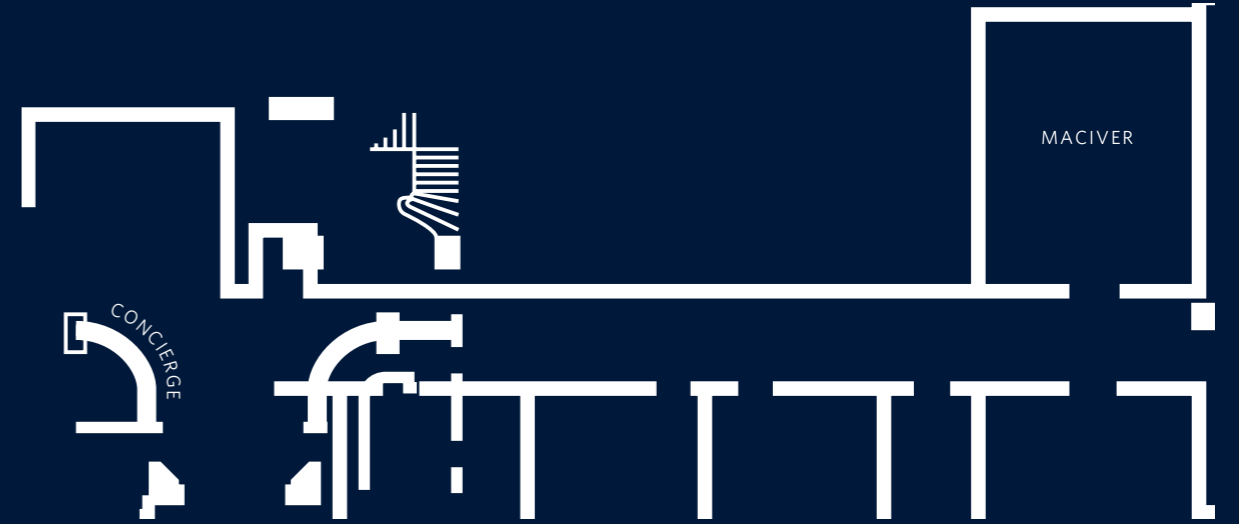

WHAT OUR CLIENTS ARE SAYING ABOUT US

Event organiser, Procurement Professional, October 2016

"We loved this hotel. The restaurant layout and food is very good. It's convenient for anyone coming into Heathrow, the coffee area outside the room works extremely well, the room itself is more spacious and quieter being at the bottom of the corridor"

Social Dinner Event organiser, Educational Institute, September 2016

"I would just like to say on behalf of myself first. I couldn't have been happier in booking with the Hilton London Paddington, your service advice and attention to detail was second to none. You was always on the other end of the phone or email and if you wasn't you returned my call straight away. You made changes at short notice even though your poor staff had to decorate the tables again in another hall, yes nothing was too much.

On behalf of our guests I have had numerous calls and emails to say what a wonderful service we had from your kitchen waiting staff and the manager who briefed me on the whole evening and asked me was this how we wanted it to go and any suggestions.

The Food: Well again Hilton pulled out all the stops and again the guests commented how lovely all three courses were. They also mentioned that they had never been to a function of a large size and the food was hot and not thrown together so big Compliments to the Chef and his staff.

Thank you very much again from me you have been a STAR and the Hilton should be lucky to have y

Learning and Development Manager, Utility Services, July 2016

"What a great evening we had. The event ran smoothly, the staff were brilliant, the operations manager was so helpful and engaging. The food and service was lovely. Thank you for all your support on the lead up to this event."

Event organiser, computing and designing, June 2016

"I just wanted to send a quick email to your events team to say a very big thank you for all of your help yesterday during our event. The assistance your team provided was exemplary throughout and all of the team here at CFMS are most grateful. Furthermore the room itself looked fantastic and was set up exactly to our requirements, the food and refreshments were excellent and every member of your staff was willing to help. We are most pleased with the service you provided."

Event organiser, international pharmaceutical, June 2016

"The hotel staff have been superb, and everything has run very smoothly with the meeting.

Please extend my special thanks to Salesh and Abraham and the other lady (I forget her name, but she has been helping the whole time) also the lady taking care of breakfast provided a great service.

I have enjoyed the meeting and felt taken care of by the staff, and we have a happy client.

Looking forward to working with you again in the future."

Global medical company, June 2016

"I wanted to say thank you for the wonderful, seamless program that we had over the last couple of days. Your staff once again was "on" for anything and everything!"

Mining Company Conference, May 2016

"I just wanted to drop you a note of thanks for the outstanding service you and your team provided to us in Sept 2014. The staff did an excellent job and were always ready to help us with every need. Particularly Suranga, the manager who was assigned to help us on the Sunday night and Tuesday night activities at the hotel. Suranga was very patient, helpful and delightful to work with. Please extend our thanks and accolades for a job very well done.

All the staff throughout the hotel were very courteous and helpful. Another individual who was always very helpful and friendly was Prasanna at the Concierge desk. He found many ways to help us and make our stay and logistics comfortable.

Thanks also to you for arranging such comfortable accommodation for me and my family. We greatly appreciated all the hospitality. The Paddington Hilton was our "home away from home" when we moved to London in 2011 and when we moved away from London in 2013. It continues to be a place that is part of our very fond memories of London. "

EAT & DRINK

THE BRASSERIE

Savour locally-sourced English cuisine with an enticing Asian influence. Open for breakfast, lunch and dinner, this popular restaurant offers a menu that caters for all tastes.

146 PADDINGTON BAR

Inspired by a location steeped in locomotive history and set to become as iconic as the station in which it can be found, 146 Paddington is the perfect place to relax and unwind in comfort, enjoying a crafted Champagne cocktail created by our mixologists or sampling our street food-inspired all-day menu.

ROOM SERVICE

After a long day, enjoy a warmly-prepared meal in the comfort of your guest room. With 24-hour service and a variety of classic dishes, our in-room dining offers something for everyone.



OUR FACILITIES

HILTON FITNESS BY PRECOR®

Personalised fitness for a balanced lifestyle while on the road. Featuring the latest generation of cardio and strength training equipment, Hilton Fitness by Precor® takes a personalised approach to help you feel your best during your stay.

EXECUTIVE LOUNGE

Escape into a quiet exclusive sanctuary that helps you to unwind or work in peace. Complimentary food and refreshments are served throughout the day, while all the business services are provided with guests in mind. Private flexible meeting rooms are available to hire by the hour, half or full day.





THINGS TO DO

LOCAL ATTRACTIONS

Ideally based for exploring the surrounding popular attractions, Hilton London Paddington is within walking distance from the picturesque Little Venice by the Regent's Canal, where guests can take a historic boat by the canal and visit ZSL London Zoo.

One of London's finest landscapes, Hyde Park, is only a 10-minute walk and offers a range of events every month. Ideal for jogging, horse riding or just a relaxing walk, with its 4,000 trees, a lake and a meadow, it is easy to forget you are in the middle of busy London.

The world of high street shopping has never been closer. Within less than a mile reach is Oxford Street, Europe's busiest shopping street, home to a number of major department stores.

LONDON HAS A LOT OF TREASURES TO SHOW

London is a diverse and exciting city with some of the world's best sights, attractions and activities. With so much to do, finding the right thing is never a problem - from walk in the park and free museums to famous attractions and award-winning entertainment performances.

See the whole city from above on the London Eye where a private cabin can be booked or meet celebrities at Madame Tussauds and walk on the red carpet for a day. If passionate about history, explore the world's most precious treasures at the British Museum or bravely face dinosaurs at the National History Museum.

EXPLORE OUTSIDE LONDON FOR A DAY

With Hilton London Paddington connected to the Paddington Station via footbridge, exploring famous destinations outside London has never been easier.

Take a train for a day trip and travel on Brunel's Great Western Mainline and visit Bristol, a city filled with his legacy or the breathtaking Roman Baths in Bath. Don't forget to spend a day in Windsor, home to its stunning Windsor Castle, where the Queen still spends her weekends, making it the largest and oldest inhabited castle in the world.

SHOPPING IN LONDON

With 4 underground lines on the doorstep - Circle, Hammersmith & City, District and Bakerloo, getting around the city has never been easier for work or to visit the major attractions. Great Western Railway trains from Paddington Station connect you to the West Country to explore famous landmarks such as Bath City or the Queen's Castle in Windsor. Hop-on and Hop-off London bus tours right outside the hotel and take you all around the capital. Whilst here explore the vast number of well-known shopping destinations and treat yourself to a shopping therapy.



BICESTER VILLAGE

Spend a day in Bicester Village with more than 130 boutique brands to choose from. Speak to our Concierge for a VIP Pass and to arrange a visit. Get there with a train from London Marylebone (two stops away from Paddington Station) to Bicester in just 46 minutes.



OXFORD STREET

Visit Europe's busiest shopping street, Oxford Street, with around 300 shops and numerous restaurants and cafes along the way. For the full experience, start the day with a hearty full English breakfast, indulge yourself in a traditional Afternoon Tea and the famous Fish & Chips. Don't miss out on visiting Selfridges (below), voted the world's best department store with over 300 stores to enjoy.



paddington.hilton.com

HILTON LONDON PADDINGTON
146 Praed Street | London | W2 1EE | United Kingdom

T: +44 (0)20 7850 0500
F: +44 (0)20 7850 0600
E: events.paddington@hilton.com

